

Midland

ENGINEERING GRADE COMPOSITE VALVES

PRODUCT BULLETIN

ENGINEERING GRADE COMPOSITE IS A NEW GENERATION OF TOUGH, LIGHT, CORROSION-RESISTANT MATERIALS SPECIALLY DEVELOPED FOR HEAVY DUTY APPLICATIONS.

Midland is a leader in materials technology, with a full time composites engineer on staff to translate customer needs into the proper materials applications.

EGC MEANS ADDED VALUE

- Corrosion resistance. EGC valves don't corrode, so you'll never have to replace them because of corrosion.
- Lower cost. Most EGC valves cost less than equivalent metal valves, because there are no secondary manufacturing operations. No machining, drilling, finishing. Just one precise operation.
- Molding accuracy. EGC molding is more accurate than metal die casting. So accurate, in fact, EGC valves usually require no sealants to assure proper fit and long life.
- Selectivity. A wide range of state-of-the-art EGC materials now available assure you of the proper material to fit any application.
- Weight savings. Today's operating conditions demand that heavy duty vehicles run as light as possible, for added fuel economy and payload capability. EGC components are much lighter than conventional metal components.

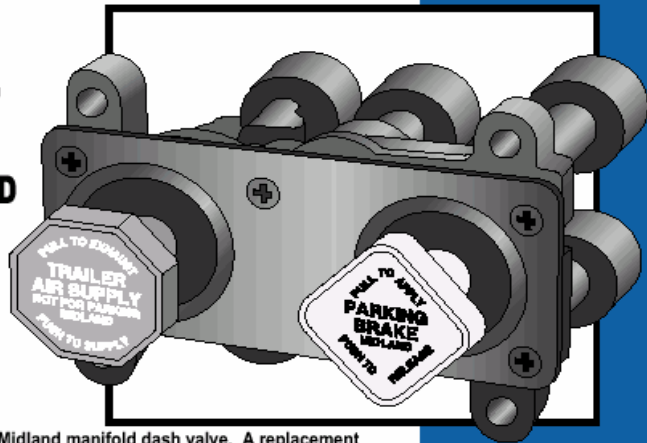

The Midland manifold dash valve. A replacement for the Bendix MV2 and MV3, this EGC valve features an improved one piece body design that eliminates leakage problems. Non-rotating molded knob is always right side up. Molded lettering will not wear off.

EGC MEANS RIGOROUS TESTING

Midland insures that each potential use for EGC is first carefully researched and tested under extreme conditions of vibration, temperature, pressure and corrosion resistance.

You can be sure your EGC products are better than they have to be.

EGC TECHNOLOGY ADDS A WHOLE NEW DIMENSION TO THE DESIGN AND PERFORMANCE OF HEAVY DUTY TRUCK COMPONENT PARTS

It's a dimension of improved economy and durability.

Midland engineers are pioneering the use of EGC technology so you can operate with the best product for the money you spend.

That way you can be concerned with profits instead of problems. Specify EGC from Midland.

Haldex

Brake Systems

pbr
DON'T STOP WITHOUT US

EGC VALVE SPECIFICATIONS

QUICK RELEASE VALVE

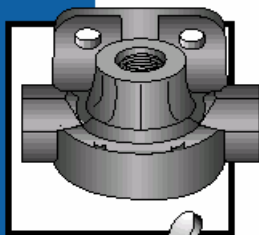

Service Number	OEM Number	Inlet Port	Outlet Del. Port	Differential
KN32005	N20959EB	3/8	3/8	0 psi
KN32011	N20959EA	1/2	3/8	0 psi
KN32050	N20950DA	1/2	3/8	6 psi
KN32060	N20950DB	3/8	3/8	6 psi

FLIPPER VALVE

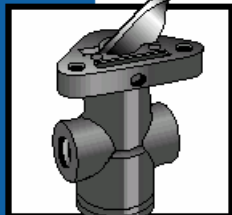

Service Number	OEM Number	Inlet Port	Outlet Del. Port	Operating Style
KN20001	N13440DL	1/8	(2) 1/8	Chrome Handle
KN20041	N13440DF	1/8	(2) 1/8	Bowden Wire

HAND CONTROL VALVE

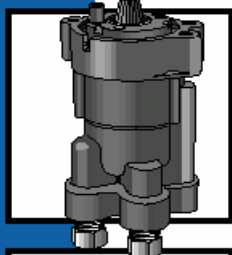

Service Number	OEM Number	Supply Port	Delivery Port	Exhaust Port	Operating Style
KN20541	N30103BB	1/4	1/4	1/4	Holding
KN20551	N30107BC	3/8	3/8	1/8	Holding
KN20552	N30107BD	3/8	3/8	1/8	Self-Return

MANIFOLD DASH VALVE

(Replacements For Bendix MV2 & MV3 Valves)

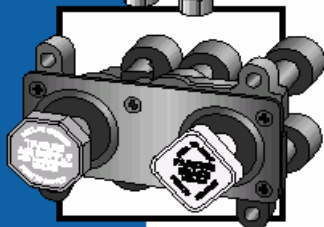

Service Number	OEM Number	All Ports	Trailer Valve POP Pressure	Parking Valve POP Pressure	Non-Override POP Pressure
KN20611	N4400B	1/4 NPTF	40 ± 5 psi	30 ± 5 psi	25 ± 5 psi
KN20612	N4400A	1/4 NPTF	40 ± 5 psi	30 ± 5 psi	25 ± 5 psi
KN20615	N4400	1/4 NPTF	40 ± 5 psi	30 ± 5 psi	25 ± 5 psi

DASH VALVE

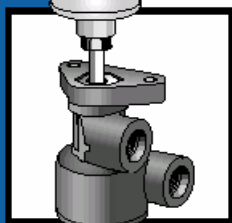

Service Number	OEM Number	Supply Port	Delivery Port	POP Pressure
KN20031	N20938CK	1/4	1/4	25-30 psi
KN20033	N20928CH	1/4	1/4	7-17 psi

QUICK RELEASE VALVE

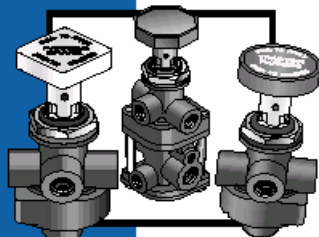

Service Number	OEM Number	Replacement For	Supply Port	Delivery Port	POP Pressure
KN20021	N20960	Bendix PP1	1/8-27 PTF	1/8-27 PTF	35±10 psi
KN20025	N20961	Bendix PP7	1/8-27 NPTF	1/4-18 NPTF	35±10 psi
KN20035	N20964	Bendix PP8	1/8-27 NPTF	1/8-27 NPTF	17.5±12.5 psi

Haldex

Brake Systems

PBR Australia

264 East Boundary Rd East Bentleigh

Victoria 3165

Phone 1300 369 727

www.pbr.com.au

